

KERES PLUS



KERES PLUS 28"



USER MANUAL

INDEX

1. FOREWARD	3
1.1 Generalities	3
1.2 Assistance	3
1.3 Graphical form of safety events	3
2. SECURITY WARNINGS	4
2.1 Liability	4
2.2 Warnings For The users	5
2.3 Warnings For the maintenance	5
3. UNPACKING AND SETTING UP	6
3.1 Battery charging	6
3.2 Saddle Adjustment	6
3.3 Pedals assembly	7
3.4 Wheels	7
3.5 Brakes	8
4. DESCRIPTION OF THE BICYCLE	9
4.1 Data sheet	9
4.2 Levers of the brakes	10
4.3 Speed change	10
4.4 Management assistance	11
4.4.1 <i>Power on - Shutdown of the system</i>	11
4.4.2 <i>Levels Of assistance</i>	11
4.5 Battery	12
4.5.1 <i>State load battery</i>	12
4.5.2 <i>Loading battery</i>	12
4.5.3 <i>Errors</i>	13
4.5.4 <i>Supplementary battery</i>	14
5. FSA SYSTEM APPLICATION	15
5.1 Registration And connection	15
5.2 Update firmware	16
5.3 Diagnostics	17
5.4 Accounts user	18
6. CONDITIONS OF USE AND ENVIRONMENTS EXPECTED	19
6.1 Use expected	19
6.2 Environment of use	19
6.3 Improper usage	20

7. LIFT AND TRANSPORT	20
7.1 Lifting	20
7.2 Transportation	21
8. USE OF THE BICYCLE	21
8.1 Usage of the bicycle	22
8.2 Braking	22
8.3 Parking of the bicycle	22
9. MAINTENANCE	23
9.1 Generalities	23
9.2 Maintenance and daily check	23
9.2.1 <i>Check Of tags and pictogram</i>	23
9.2.2 <i>Check of the wheels</i>	23
9.2.3 <i>Check brakes</i>	23
9.3 Maintenance and weekly check	24
9.3.1 <i>Wash and cleaning</i>	24
9.3.2 <i>Lubricating and voltage chain check</i>	24
9.3.3 <i>Check of the frame and bolts</i>	24
9.4 Maintenance and monthly check	25
9.4.1 <i>Check of the circuits and of the electrical components</i>	25
9.4.2 <i>Check and regulation of the backside rear</i>	25
10. TECHNICAL ASSISTANCE AND SPARE PARTS	26
11. DEPOSIT TO WAREHOUSE	26
12. DISPOSAL OF COMPONENTS AND MATERIALS	26
13. WARRANTY STANDARDS	27
14. CONFORMITY	28



1. FOREWARD

1.1 Generalities

This manual is an integral and essential part of the KERES PLUS model pedal assisted bicycle. Before commissioning, it is essential to read and understand the following provisions. The manufacturer is not liable for damage caused to people and/or things or to pedal assisted bicycles if they are used incorrectly respect to the instructions indicated. With a view to continuous technological development, the manufacturer reserves the right to modify the components, including the frame, without notice and without this manual being automatically updated.

1.2 Assistance

For any inconvenience or request for clarification, contact the authorized dealer, who has competent and specialized personnel, as well as specific equipment and original spare parts.

1.3 Graphical form of safety events

To identify the safety messages in this manual, the following graphic signaling symbols will be used. They have the function of attracting the attention of the reader / user for the purposes of correct and safe use of the pedal assisted bicycle.



ATTENTION

It highlights rules of conduct to be followed in order to avoid damage to the pedal assisted bicycle and/or the occurrence of dangerous situations.



DANGER

It highlights the presence of dangers that cause residual risks to which the user must pay attention in order to avoid accidents or damage to property.

2. SECURITY WARNINGS



ATTENTION

USE OF THE PEDAL ASSISTED BICYCLE

Each user must first read the instruction manual, especially the chapter on safety instructions.



ATTENTION

RISKS ASSOCIATED WITH THE USE OF THE PEDAL ASSISTED BICYCLE

- Despite the application of the safety devices, for safe use of the pedal assisted bicycle you must take note of all the prescriptions relating to the prevention of accidents contained in this manual.
- Always stay focused while riding and **DO NOT** underestimate the residual risks connected with the use of the pedal assisted bicycle.

Even if you are already familiar with the use of pedal assisted bicycles, it is necessary to follow the instructions contained herein, in addition to the general precautions to be observed when driving a motorized vehicle. In particular:

- Acquire full knowledge of the pedal assisted bicycle;
- Read the manual carefully to learn about the operation, the safety devices and all the precautions necessary for the safe use of the vehicle. All this to allow safe use;
- Carefully maintain the pedal assisted bicycle in perfect working order.
- For any inconvenience or request for clarification, do not hesitate to contact the authorized dealer, who has competent and specialized personnel, specific equipment and original spare parts.

2.2 Liability

Failure to comply with the operating instructions and safety prescriptions contained in this manual exempts the manufacturer from any liability.

If the maintenance of the pedal assisted bicycle is carried out in a way that does not comply with the instructions supplied, with non-original spare parts or in any case in such a way as to jeopardize its integrity or modify its characteristics, the manufacturer will deem himself relieved of any responsibility relating to safety of people and malfunctioning of the pedal assisted bicycle.



DANGER

INCORRECT AND UNINTENDED USE

The pedal assisted bicycle is designed and built to be used outdoors, on roads and in private or public environments. A different use and the non-compliance with the technical parameters set by the Manufacturer can constitute a danger for the users.





ATTENTION

UNAUTHORIZED MODIFICATIONS

If you hear unusual noises, or feel something strange, stop the pedal assisted bicycle immediately. Then carry out a check and, if necessary, contact your authorized dealer.

For any data that is not included or cannot be deduced from this manual, it is recommended to consult the authorized dealer directly.

2.2 Warnings for users

1. It is forbidden to carry a passenger.
2. Only to be used by experienced adults and children.
3. Do not take alcohol or drugs before riding the pedal assisted bicycle.
4. These pedal assisted bicycle models are designed and built to be used outdoors, on roads and in private and public environments.
5. Do not ask the pedal assisted bicycle to perform in excess of what it was designed for.
6. Never ride the pedal assisted bicycle with parts removed.
7. Ride with both hands on the handlebars.
8. Replace worn and/or damaged parts and check that the guards work properly before use.

2.3 Warnings for the maintenance

1. All maintenance operations must be carried out with the battery disconnected.
2. During each maintenance phase, the operators must be equipped with the necessary accident prevention equipment.
3. The tools used for maintenance must be suitable and of good quality.
4. Do not use gasoline or flammable solvents as cleaners, always use non-flammable and non-toxic solvents.
5. Limit the use of compressed air for cleaning as much as possible (max 2 bar) and protect yourself with goggles with side guards.
6. Never resort to the use of open flames as a means of lighting when carrying out checks or maintenance operations.
7. After each maintenance or adjustment operation, make sure that no tools or foreign bodies remain between the moving parts of the pedal assisted bicycle.



ATTENTION

ORIGINAL REPLACEMENTS

Only use original spare parts supplied by M.B.M. S.r.l. Single-member.
The Manufacturer is excluded from any liability for damage or loss of functionality caused by the use of non-original accessories and parts.



DANGER

DANGER:

It is strictly forbidden, therefore, to modify or remove the guards, controls, labels and indication plates.



3 UNPACKING AND SETTING UP

The pedal assisted bicycle is delivered fully assembled and functional. Before each use, the driver must check the safety status of the pedal assisted bicycle. Therefore, perform the following inspections before riding the pedal assist bicycle.

3.1 Battery charging

Before using the bicycle for the first time, charge the battery for at least 8 hours, using the special battery charger supplied. The bicycle is equipped with an electric motor powered by a 36 V lithium-ion battery. The average recharge time varies from 4 to 6 hours. The recharging operation can be carried out in a well-ventilated box with the battery installed on the bicycle. To charge the battery, proceed as in **paragraph 4.6.2**



DANGER

PRECAUTIONS WHEN CHARGING

- First connect the plug to the battery and then the power plug to the mains;
 - When recharging is completed, always disconnect the plug from the mains first and then the plug from the battery;
 - Always fully recharge the battery;
 - Always use the original power supply supplied;
 - Do not leave the battery charged for more than 8 hours;
 - Always recharge in a ventilated environment;
 - Do not recharge the battery in too hot environments;
 - Do not recharge the battery near flammable liquids;
 - Do not cover the battery in any way during recharging;
 - If the battery emits a bad smell, immediately disconnect the plug from the power supply and ventilate the room.
- Do not touch the battery.

3.2 Saddle Adjustment

Adjusting the height of the saddle is an essential prerogative for the correct use of the pedal assisted bicycle. Incorrect adjustment can generate structural breaks in the frame. Adjust the height of the saddle using the screw located in the collar (Ref. A - Fig. 1). Verify that the mechanism is tightened before testing the seat and using the vehicle. Do not tighten the collar screw (Ref. A - Fig. 1) beyond the maximum value of 8 Nm. Do not lift the saddle beyond the limit switch signal located in the tube (Ref. B - Fig. 1).

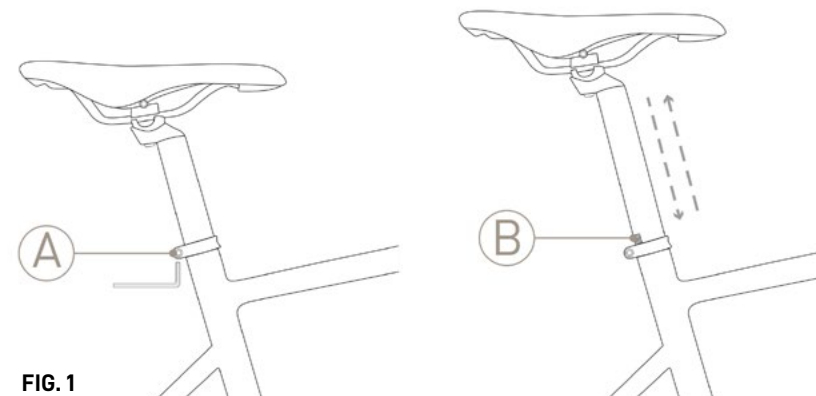

FIG. 1

**DANGER**

Important warning:
For your safety, the seat post reference mark (B) should never be outside the seat post tube.

**ATTENTION****PACKING**

In the event that you do not have the appropriate instrumentation for the adjustment or you do not have the skills, contact the authorized dealer.

3.3 Pedals assembly

Right Pedal: identified by the letter R marked on its pin. To assemble the pedal, screw it in by turning the pin clockwise. (Fig.2)

Left Pedal: identified by the letter L marked on its pin. To fit the pedal, screw it in by turning the pin counterclockwise. (Fig.2)

**ATTENTION****PACKING**

In the event that you do not have the appropriate instrumentation for adjustment or do not possess the skills, contact your authorized dealer.

3.4 Wheels

Check the tire inflation pressure. Check the state of wear of the tread: there must be no cuts, cracks, foreign bodies, abnormal swellings, visible plies and other damages.

**ATTENTION**

Do not inflate the tires beyond the admissible value indicated by the manufacturer on the side surface of the same

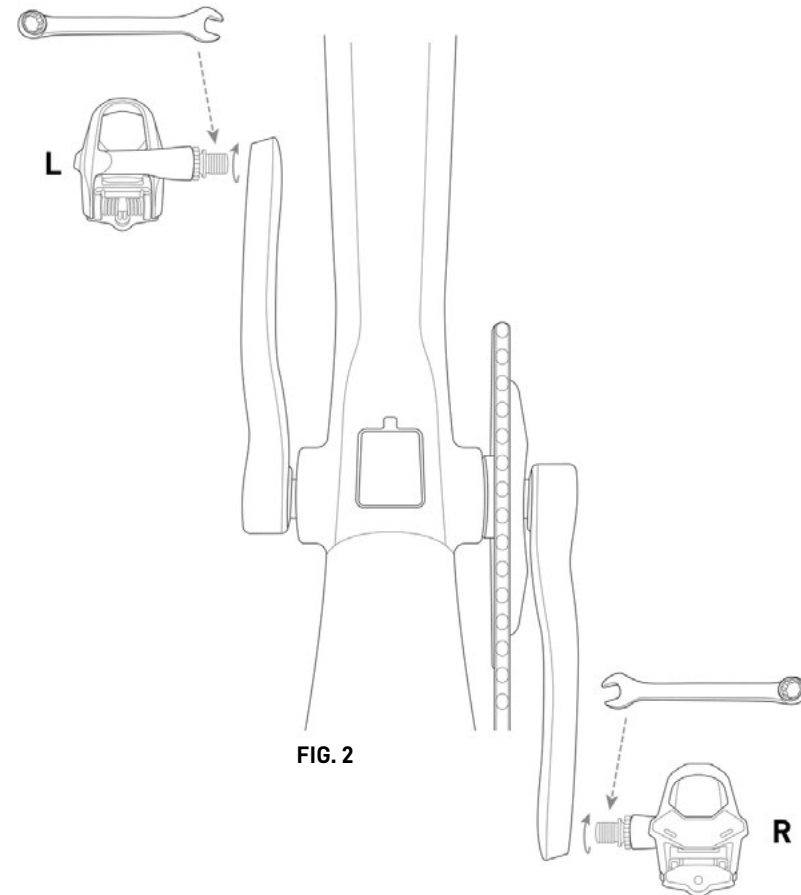
**FIG. 2**

3.5 Brakes

Visually inspect the braking system, checking that there are no damaged cables or lubricants on the braking surfaces of the brake and rim. Check the operation of the brakes by testing the brakes at low speed in an obstacle-free area, first with the rear brake and then with the front brake.



ATTENTION

NEGATIVE VERIFICATION

In case that, during the preliminary checks, defects of any kind are found and even one check is negative, **DO NOT RIDE THE BIKE WITH PEDAL ASSISTANCE**. Immediately take all measures to carry out a suitable repair and, if necessary, contact your authorized dealer or an authorized workshop.



4. DESCRIPTION OF THE BICYCLE

4.1 Data sheet

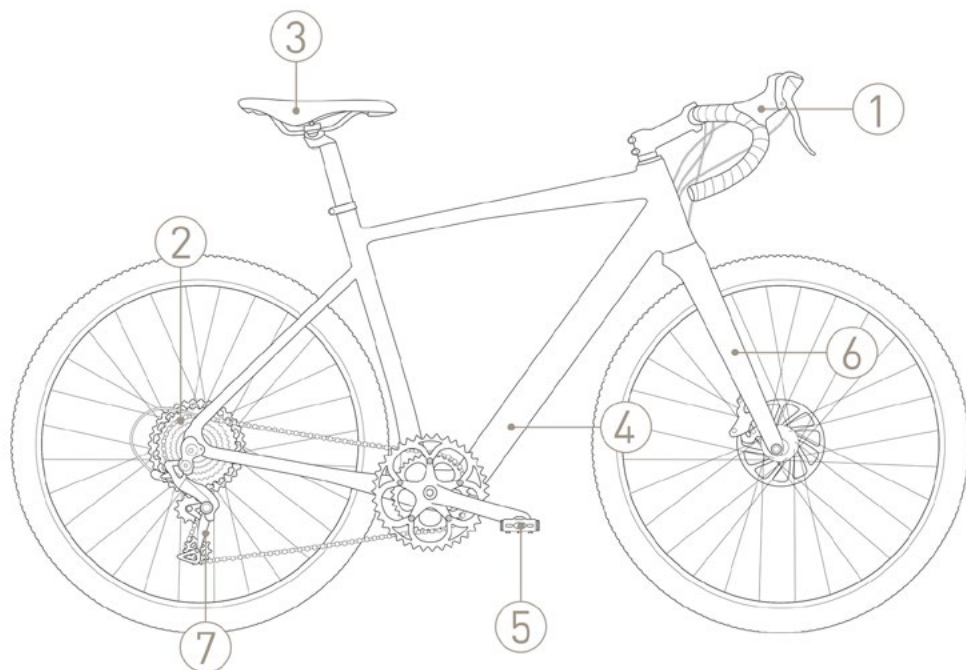

1. HANDLEBAR AND CONTROLS
2. HUB MOTOR
3. SADDLE
4. BUILT-IN BATTERY
5. PEDALS
6. FORK
7. SHIFTER

CODE	E575PL
FRAME	HYDROFORMED ALUMINUM
FORK	CARBON MONOCOQUE
CRANKSET	40
SHIFTER	SRAM APEX 1 11S
SHIFTER COMMAND	11 SPEEDS
BRAKES	SRAM APEX 1 HYDRAULIC DISC BRAKE
DISKS	SRAM CENTERLINE 160 F / 160 R
TIRES	WTB RIDDLER 700X37C
SADDLE	SADDLE SAN MARCO SHORTFIT
PEDALS	RIGHT AND LEFT IN STEEL AND POLYMER MATERIAL
MOTOR	FSA SYSTEM HM 1.0 42 NM
BATTERY	FSA SYSTEM HM 1.0 36V, 7AH, 252 WH
MAX. SPEED ASSISTED	25 KM/H
DISPLAY	LCD
WEIGHT	15 KG



4.2 Levers of the brakers

The brake levers (Ref. C - Fig. 3) are located on the handlebar of the pedal assisted bicycle. These systems make it possible to control the brake disc calipers, located near the wheel hubs. The right lever controls the rear brake, the left one the front brake; the braking action is proportional to the force applied to the lever.

4.3 Speed change

The pedal assisted bicycle has an 11-speed gearbox with the sprockets positioned on the rear wheel hub and selectable using the opposing levers located at the base of the right knob. The indicator (Ref. E - Fig 3) in the upper part of the handlebar allows you to view the selected ratio.

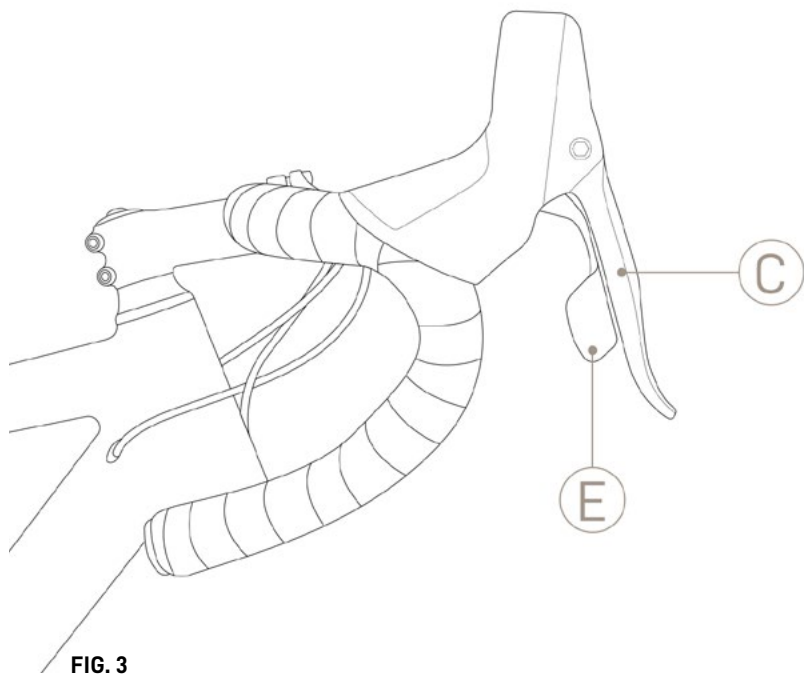

4.4 Management assistance

4.4.1 Power on and shutdown of the system

The bicycle provides pedaling assistance through an electric motor powered by the battery located inside the down tube.

The system that provides assisted pedaling can be turned on by pressing the appropriate button on the upper tube (Fig. 4).

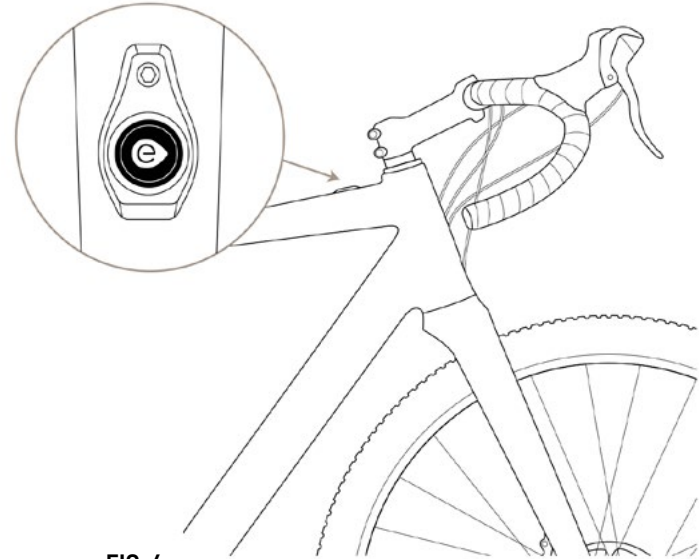

FIG. 4

- ON: press and hold the button for 1 second
- OFF: press and hold the button for 4 seconds

4.4.2 Levels of assistance

The system automatically selects the ECO level (green colour) after switching on.



Before starting pedalling, wait for the button to turn green.
The system requires the bicycle to be completely stationary in order to calibrate all the sensors.

ATTENTION

To select the level of assistance, press the power button until you reach the desired level.

LEVEL 1	LEVEL 2	LEVEL 3	LEVEL 4	LEVEL 5
ECO: Green flash	Blue flash	Pink flash	Yellow flash	Red flash
Neutral	Active	Active	Active	Active







4.5 Battery

The bicycle provides pedaling assistance through an electric motor powered by the battery placed inside the down tube.

4.5.1 State load battery

Every two seconds the power button flashes indicating the battery status.

			
Batteria 75-100%	Batteria 50-75%	Batteria 25-50%	Batteria 25%
Green flash	Blue flash	Yellow flash	Red flash

It is also possible to check the battery status in a more accurate way using the special FSA SYSTEM application (Paragraph 5).

4.5.2 Loading battery

The battery can be recharged using the socket located near the bottom bracket (Fig.5). Lift the plastic cover of the charging socket and connect the plug of the battery charger supplied (Fig. 5.1). Once the battery charger is connected to the mains, the power button will start flashing every 2 seconds. (0.5sec ON - 1.5sec OFF)

Charging indicators:

- **RED:** In charge
- **GREEN:** Charge complete

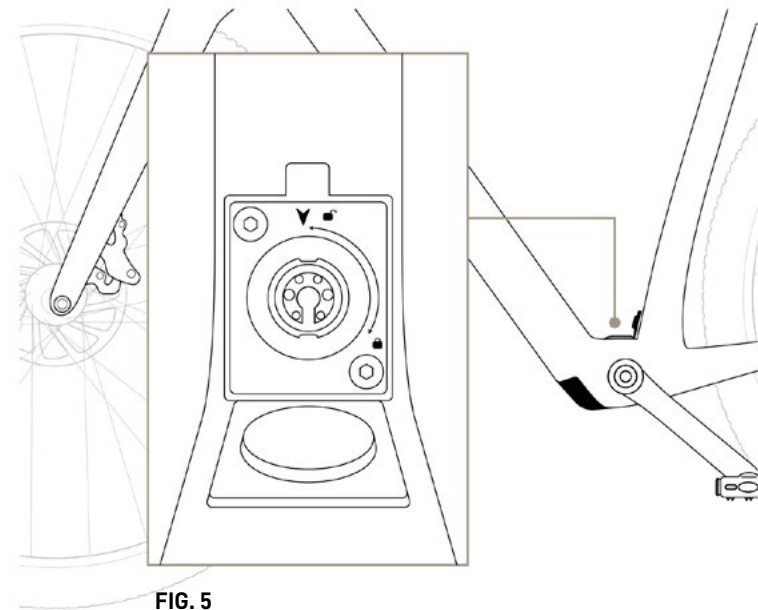

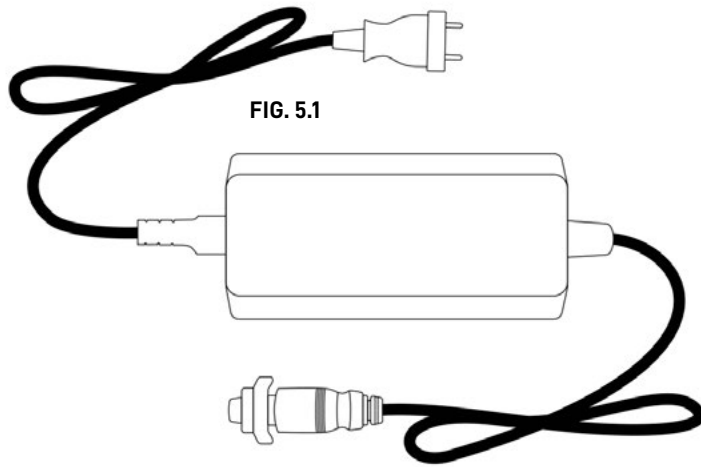

FIG. 5.1



ATTENTION

CHARGER

Always connect the plug to the battery first and then the charger to the socket.



ATTENTION

BATTERY CHARGE

The battery must not be completely discharged to preserve its life and not run the risk of damaging it. In any case, it must be recharged at least every 3 months even if the bicycle is not used.



DANGER

PRECAUTIONS WHEN CHARGING

- First connect the plug to the battery and then the power plug to the mains;
- When recharging is completed, always disconnect the plug from the mains first and then the plug from the battery;
- Always fully recharge the battery;
- Always use the original power supply supplied;
- Do not leave the battery charged for more than 8 hours;
- Always recharge in a ventilated environment;
- Do not recharge the battery in too hot environments;
- Do not recharge the battery near flammable liquids;
- Do not cover the battery in any way during recharging;
- If the battery emits a bad smell, immediately disconnect the plug from the power supply and ventilate the room.
Do not touch the battery.

4.5.3 Errors

In case of errors or failures, the system marks them with yellow or red flashes:

- **YELLOW:** errore temporaneo (0,5 sec ON - 0,5 sec OFF)
- **RED:**
 1. The battery is not connected to the controller or CAN-bus. (0.5sec ON - 9.5sec OFF)
 2. The battery is charging. The charge level is at minimum (0.5 sec ON - 4.5 sec OFF)
 3. Permanent fault, disconnect battery (0.5 sec ON - 0.5 sec OFF)



4.5.4 Supplementary battery*

The additional FSA E-System LI-ION 252 Wh/7 Ah 36V battery (Fig. 6) can be housed in place of the bottle holder and can be connected directly to the charging socket (Fig.5).

The supplementary battery must be housed in the special holder supplied by FAS and secured with the two screws supplied (Fig.6.1).



FIG. 6.1

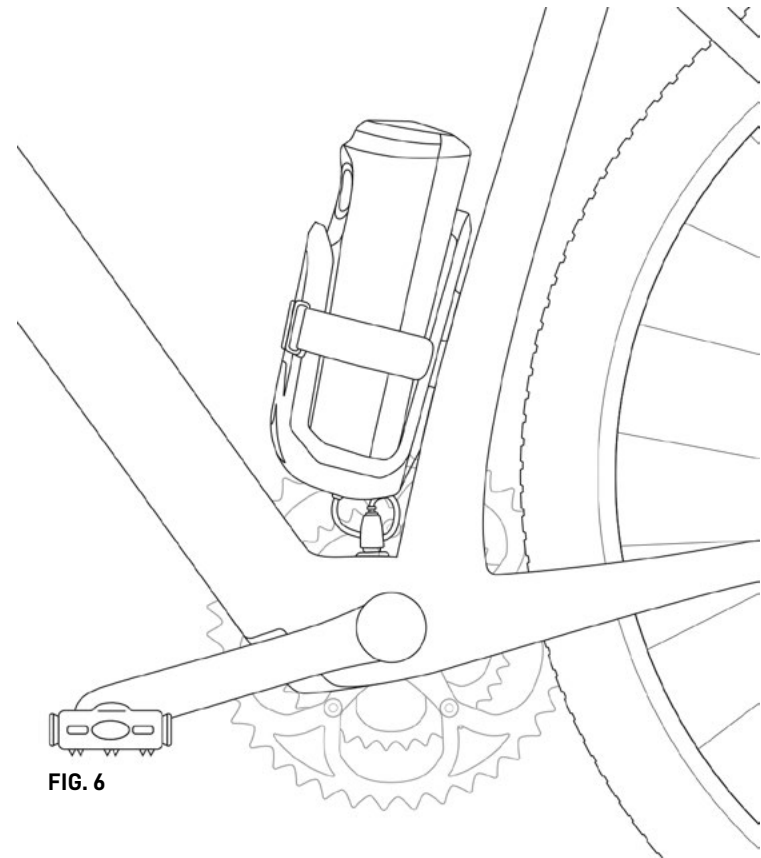

FIG. 6

*An additional battery is sold separately.

5. FSA SYSTEM APPLICATION

Through the FSA System application it is possible to update the system firmware and check the battery status.

5.1 Registration and connection

Click on "New User", enter your data and wait for the confirmation email. After verifying your account, go back to the home page of the application and click on "Connect", the "System Number" of your bicycle will appear on the screen, select it to start the connection.

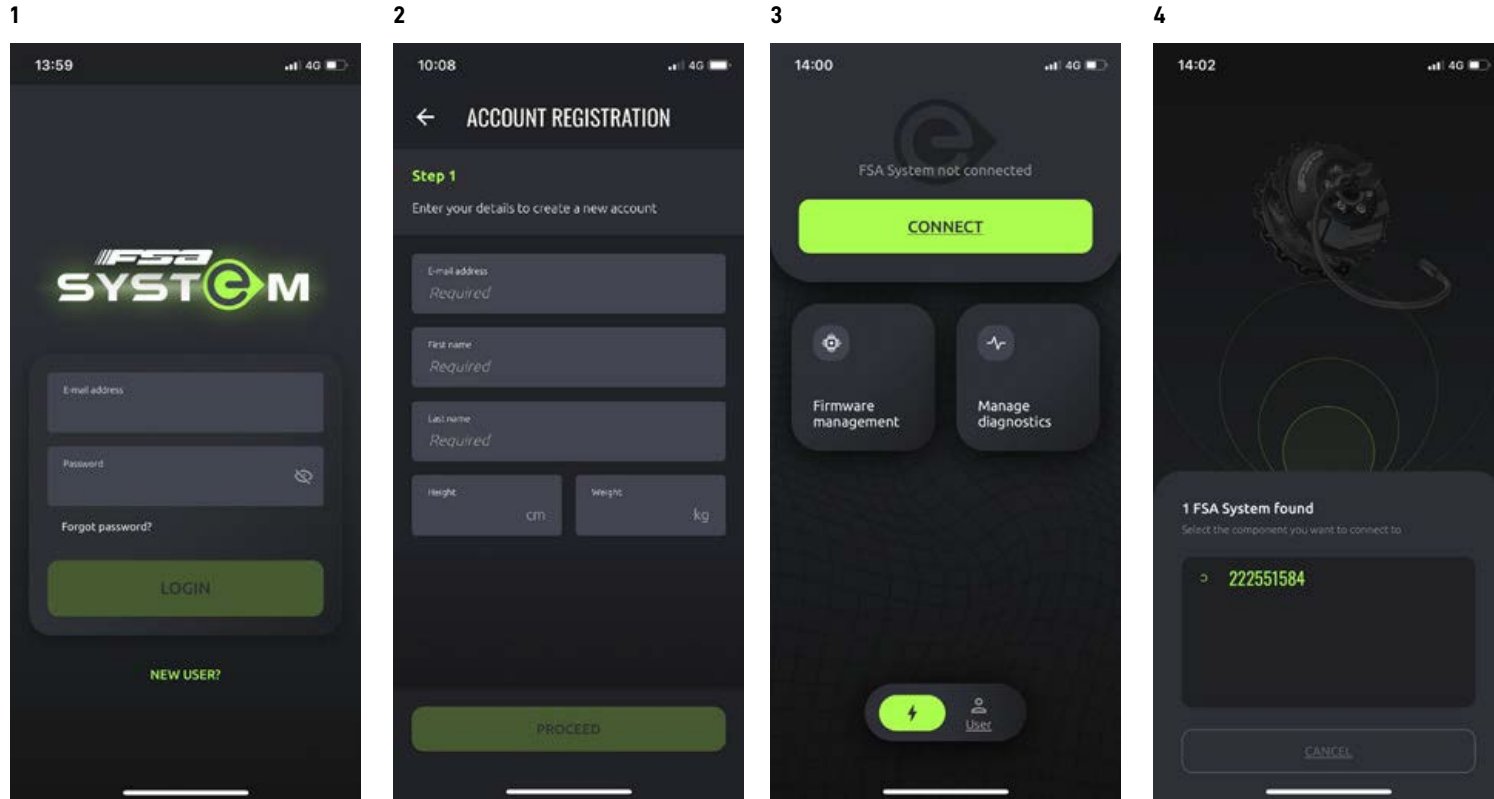

5.2 Update firmware

The number of possible updates appears above the "Firmware Management" icon. Click on the icon to enter the section dedicated to updates; after selecting the update, wait for it to complete without closing the application.

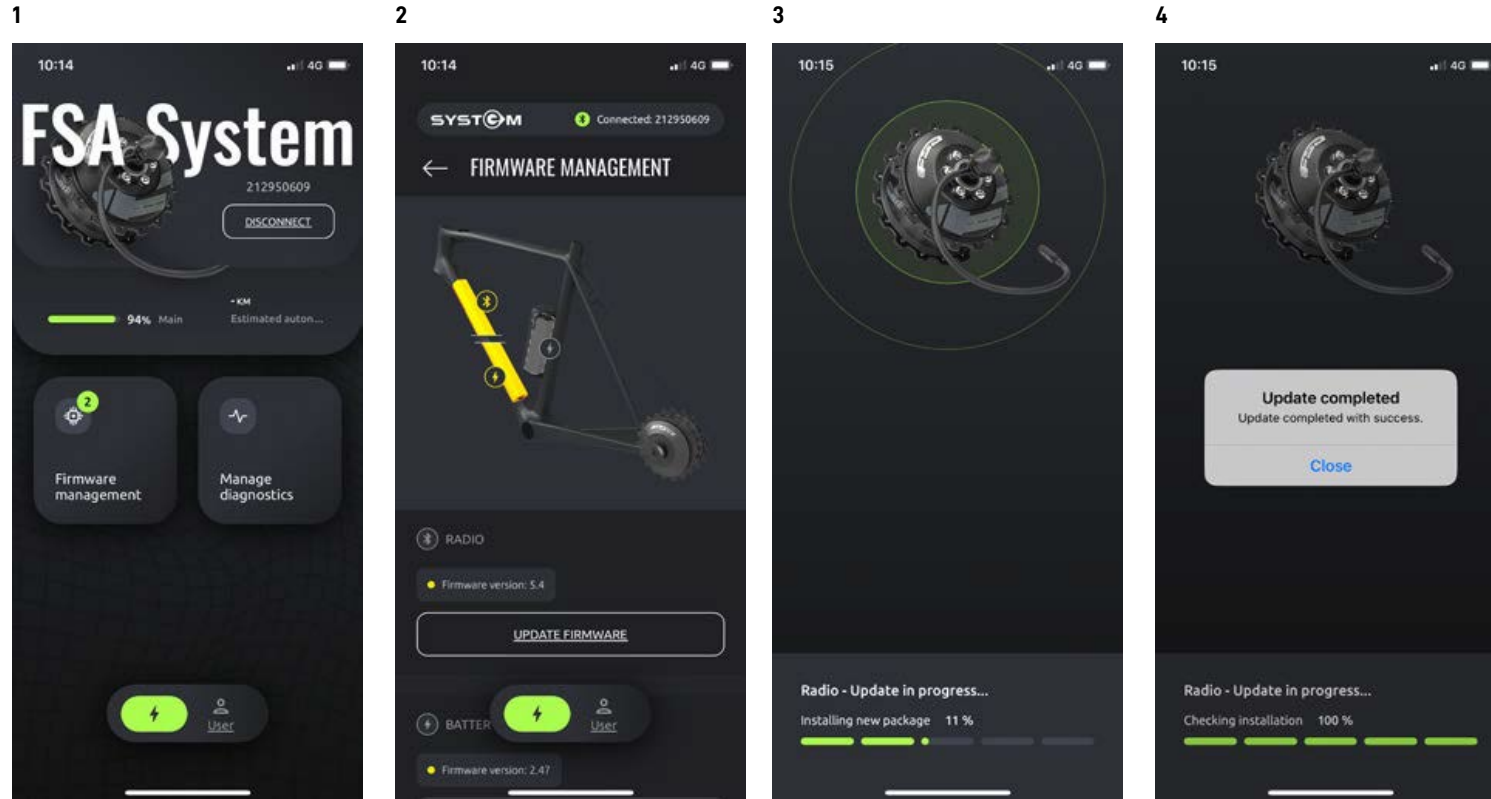

5.6 Diagnostics

Click on the "Manage diagnostic" button to enter the dedicated section. To start the analysis, click the "Generate Report" button and wait for the application to finish working without closing it. After the analysis you will find any errors in the last column of the report.

1



2

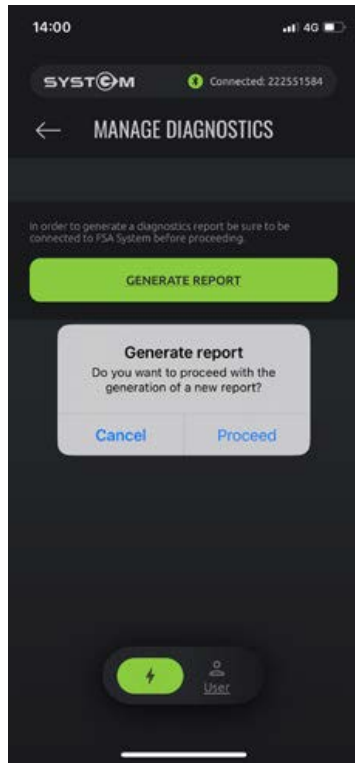

3

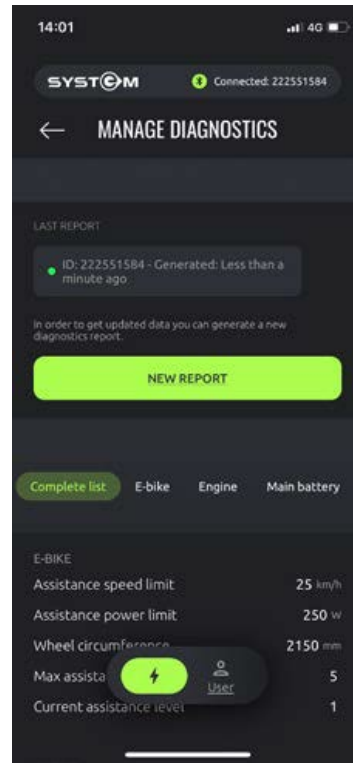

4

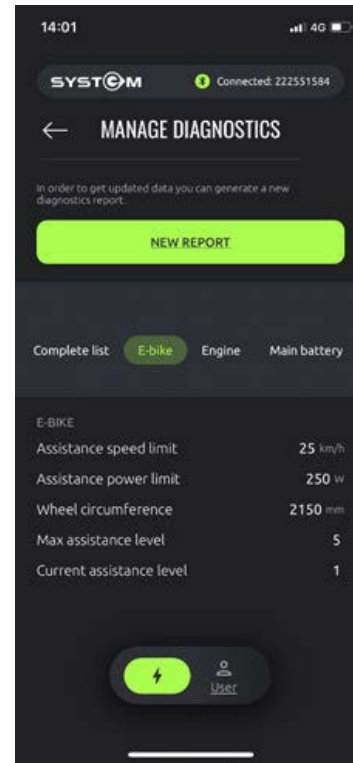

5

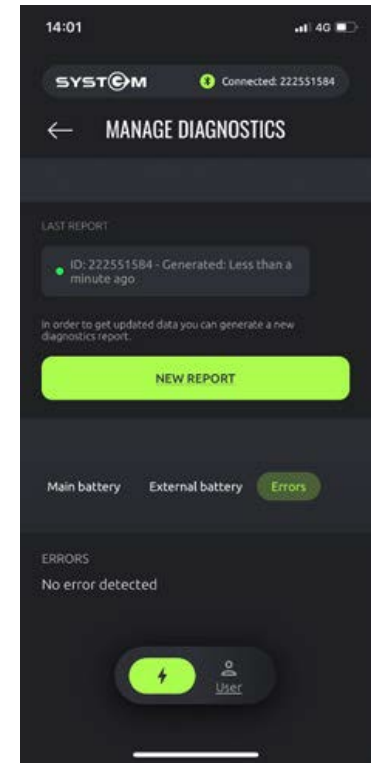

5.6 Account users

To view and edit your profile, click on "User" and then on the "Edit profile" button.

1

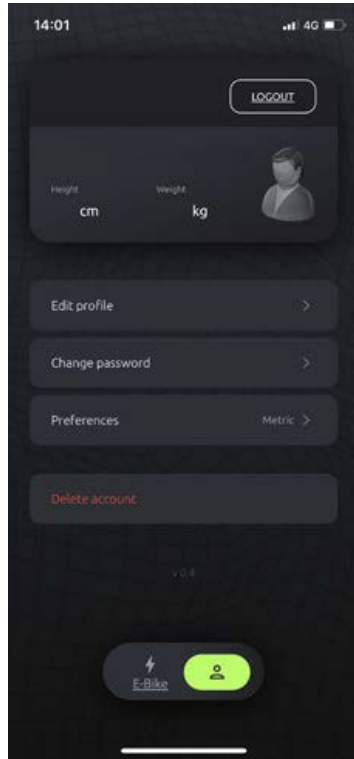

2

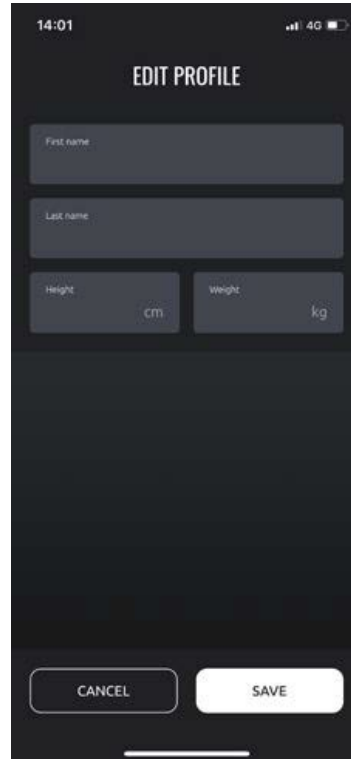

6. CONDITIONS OF USE AND ENVIRONMENTS EXPECTED

6.1 Use expected

The pedal assisted bicycle is designed and built to be used outdoors, on roads and in private or public environments. In particular, the components and the type of pedal assisted bicycle allow you to tackle routes with asphalt or dirt surfaces without particular roughness. Any modification to the state of construction can compromise the behaviour, safety and stability of the pedal assisted bicycle and can lead to an accident. Other types of use, or the extension of use beyond that foreseen, do not correspond to the destination assigned by the manufacturer and, therefore, the same cannot assume any responsibility for any resulting damage.

6.2 Environment of use

The pedal assisted bicycle can be used outdoors, in the absence of adverse weather conditions (rain, hail, snow, strong winds, etc.):

- Maximum permitted temperature: +40 °C;
- Minimum temperature allowed: 0 °C;
- Maximum humidity allowed: 70%

The environment of use may have an asphalted or dirt road surface with not particularly high roughness.

Furthermore, the place of use must be illuminated, by the sun or by artificial lights, in such a way as to guarantee the correct vision of the path and of the controls of the pedal-assisted bicycle (recommended from 300 to 500 lux).

The pedal assisted bicycle can be equipped with front white light and rear red light.



ATTENTION

FORBIDDEN ENVIRONMENT OF USE

The pedal assisted bicycle must not be used:

- In areas subject to risk of fire or explosion;
- In environments with a corrosive and/or chemically active atmosphere;
- in poorly lit environments;
- On excessively inaccessible terrain, given the characteristics of the same (chassis, wheels, etc.);
- In closed spaces, if they do not allow safe use;
- In dark environments.



6.3 IMPROPER USAGE

The actions described below, which obviously cannot cover the entire range of potential possibilities of "misuse" of the pedal assisted bicycle, are to be considered absolutely prohibited.



ATTENTION

FORBIDDEN OPERATIONS

- Carrying out prohibited operations invalidates the guarantee;
- The manufacturer declines all responsibility for any damage to people or things deriving from the execution of prohibited operations.



DANGER

ABSOLUTELY FORBIDDEN

- Driving the pedal assisted bicycle for uses other than those for which it was built, ie the pleasure of a passenger;
- Drive the pedal assisted bicycle in areas where there is a danger of explosions;
- Ride the pedal assisted bicycle in adverse weather conditions (heavy rain, hail, snow, strong wind, etc.);
- Driving the pedal assisted bicycle under the influence of alcohol or drugs;
- Ride the pedal-assisted bicycle if your weight is higher than permitted;
- Charge the battery in a too hot or insufficiently ventilated environment;
- Cover the battery while recharging;
- Smoking or using open flames near the recharging area;
- Carry out any maintenance operation with the battery connected;
- Use non-original spare parts;
- Insert your limbs or fingers between the moving parts of the bicycle;
- Use the bicycle on paved or dirt roads with obstacles greater than those permitted by the vehicle.

7. LIFTING AND TRANSPORTATION

7.1 Lifting

The weight of the KERES PLUS model pedal assisted bicycle is such that it can be lifted and carried by one person, also due to the overall dimensions. The optimal solution to carry out the handling is to grab a handlebar grip and the rear part of the saddle.



DANGER

CRUSHING AND IMPACT

- Extreme caution must be exercised during lifting to avoid damage to people and things;
- This operation must be performed by strong people.

The manufacturer is not liable for breakages due to lifting and/or transporting the pedal assisted bicycle after delivery.



7.2 Transportation

To ensure safe transport in vans, it is necessary to prevent the pedal assisted bicycle from moving. This is achieved by binding it with bands or anchor cables in good condition.

In this regard, the attachment devices must be installed in such a way as not to damage the frame and other parts of the bicycle



DANGER

INJURY RISK

ALWAYS make sure that the frame and handlebar adjustment bolts are fully tightened before each use of the bicycle. Otherwise serious injuries could result!

8.8. USE OF THE BICYCLE

The pedal assisted bicycle was designed and built for use in open places, with asphalt or dirt roads, for amateur use.

- It can only be used by experienced adults and children;
- The use of the pedal assisted bicycle is not recommended for pregnant women;
- Do not take alcohol or drugs before riding the pedal assisted bicycle;
- Do not ask the pedal assisted bicycle to perform in excess of what it was designed for. Only use the bicycle in the manner and intended use described in this manual;
- Never ride the pedal assisted bicycle with parts disassembled;
- The pedal assisted bicycle cannot be used on very wet, icy or slippery surfaces;
- Avoid very uneven surfaces and obstacles;
- Ride with both hands on the handlebars;
- Replace worn and/or damaged parts. If necessary, have it checked by authorized personnel.

Before leaving, carry out all the checks indicated in the previous chapter and always keep concentrated while driving, for your own safety and that of others.



DANGER

DANGER OF INJURY

- **Verify that all the controls are perfectly functional;**
- **Always respect the highway code.;**
- **Use the appropriate protective equipment (helmet, etc.)**



8.1 Use of the bicycle

Before using the pedal assisted bicycle in places open to traffic, familiarize yourself with the behavior of the vehicle. The first uses must be made in private environments away from traffic, other cyclists or obstacles of any kind. The driver must adapt the speed of the pedal assisted bicycle to the road conditions and the presence of other vehicles or pedestrians.

Especially when cornering, a moderate speed must be maintained (the smaller the curve radius, the lower the speed must be). When the rider stops pedaling or the speed reaches 25 km/h, the electric motor no longer provides assistance and the bicycle proceeds completely managed by the pedals.

It is essential to acquire experience in riding a pedal assisted bicycle before proceeding at high speed. If you don't want to use the motor, simply remove the battery or set the lowest level of assistance.

8.2 Braking

To reduce the stopping distances of the vehicle to a minimum, it is necessary to stop pedaling abruptly and then apply braking force gradually so as not to destabilize the vehicle.

Encourage the use of the rear brake when braking to stabilize the bicycle.



DRIVE CONDUCT

Excessive braking force can trigger harmful phenomena such as wheel locking or vehicle overturning; It is very dangerous to brake when cornering: you could lose control of the bicycle.

ATTENTION

8.3 Parking of the bicycle

The bicycle is not equipped with a side-type support stand. Therefore, before leaving the bicycle, check that the pedal assisted bicycle is placed on stable ground and that it remains in a stable position.

The bicycle must be parked in the designated parking areas and, in any case, without obstructing passageways, emergency exits, electrical panels and fire stations.



9. MAINTENANCE

9.1 Generalities

To maintain full functionality of your pedal assisted bicycle for a long time, it is necessary to carry out maintenance as prescribed, with correctness and professional skills.

After each ordinary maintenance intervention, a check on the perfect functioning of all the controls is mandatory.



DANGER

DANGER OF INJURY

During all maintenance work, follow the appropriate safety measures. All maintenance operations must be performed with the battery disconnected from the pedal assisted bicycle and from the battery charger; the bicycle must be placed in a stable manner using special support elements.

9.2 Maintenance and daily check

9.2.1 Checks of tags and pittograms

Check the legibility and presence of the CE plate, and of the warning stickers applied to the bicycle bodywork.

9.2.2 Check of the wheels

Using the special inflation valve on the rims, check the inflation pressure of the tires using a compressor and a gun with a pressure gauge, or a pump. Check the condition of the tread, the rim and the fastening of the rims to the hubs.

If you need to replace the tyres, contact your authorized dealer or a qualified tire specialist.

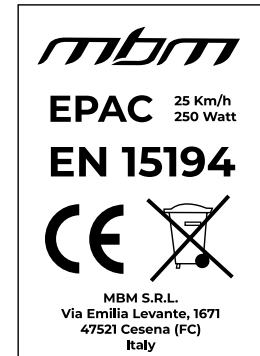

ATTENTION

Do not inflate the tires beyond the admissible value indicated by the manufacturer on the side surface of the same.

9.2.3 Check of the brakes

The brakes must be adjusted to ensure effective braking and, at the same time, the control levers must have an adequate stroke to be able to modulate the braking: in other words, the brakes must not be too slow or too tight. Check that the brake system discs and pads are not contaminated by oils or soaps. Check the effectiveness of the braking system on level ground and at low speeds. Check the wear of the brake pads every year by going to authorized personnel.





Brake adjustments should only be performed by authorized personnel.

ATTENTION

9.3 Maintenance and weekly checks

9.3.1 Washing and cleaning

Cleaning your pedal assisted bicycle is not only a matter of decorum, but also allows you to immediately detect any defect in it. To avoid damaging or compromising the functioning of the various components, especially the electrical parts, cleaning must be carried out taking certain precautions. It is absolutely forbidden to direct jets of pressurized water towards the electrical parts, the motor and the battery, for which washing with a sponge is recommended.

Before starting the pedal assisted bicycle, dry it completely with low pressure compressed air and check that there is no residual humidity on the electrical components.

9.3.2 Lubricating and voltan chain check

It is important to clean and lubricate the chain periodically to avoid corrosion due to atmospheric agents.

1. Clean the entire length of the links with a rag.
2. Spray all links with a suitable spray grease for drive chains.

Check the correct tension of the chain by positioning the rear derailleur in the two different extreme positions allowed by the sprocket pack.



DANGER

CORRECT LUBRIFICATION OF THE VOLTAN CHAIN

Be extremely careful not to get the lubricant on the brakes or the bicycle tyres. This can lead to serious injuries!

9.3.3 Check of the frame and bolts

The supporting frame of the pedal assisted bicycle and the welds must be free from visible defects such as: cracks, deformation, incisions, corrosion, etc.

Make sure that all bolts of the pedal assisted bicycle are well tightened.



9.4 Maintenance and monthly checks

9.4.1 Check of the circuits and the electrical components

Check the condition and fastening of the battery cables: the sheaths of the electric cables must be in good condition and the terminals must be well tightened, not corroded and covered with insulating grease.

Check that all bulbs and warning lights come on correctly.

9.4.1 Check and regulation of the backside rear

Adjustment of the lower and upper limit switches of the gearbox:

Turn the two screws (Ref. U-T- Fig. 12) so that the chain does not come out.

The chain shifter should be in line with both the largest and smallest cog. (Ref. Fig. 13)

Regulation inferior limit

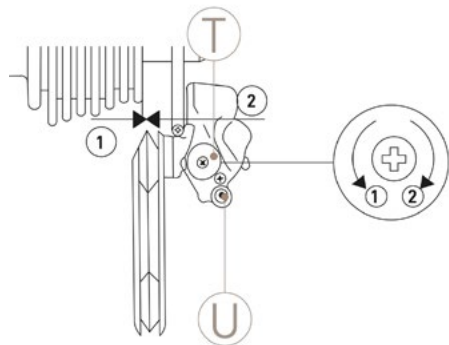

FIG. 12

Regulation upper limit

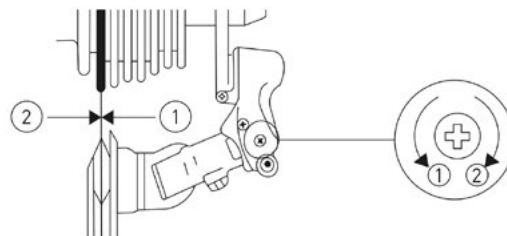

FIG. 13

Adjust the tension of the cable by acting on the appropriate control to guarantee the immediate response of the rear derailleur to the control of the small lever on the handlebar. (Ref. Fig. 14)

To prevent damage to the gearbox, it is recommended not to exert too much pressure on the pedals while changing gear. So avoid shifting when exerting effort or driving on slopes.

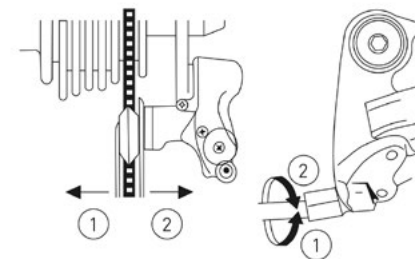

FIG. 14

10. TECHNICAL ASSISTANCE AND SPARE PARTS

If you need technical assistance, contact your authorized dealer.
In case of installation of non-original parts, the guarantee becomes void!



ATTENTION

ORIGINAL REPLACEMENTS
The manufacturer declines all responsibility for damages of any kind caused by the use of non-original spare parts.

11. DEPOSIT TO WHAREHOUSE

In the event that the pedal assisted bicycle has to be stored and stored for long periods of inactivity, the following operations must be carried out:

- Repair it in a dry and ventilated place;
- Carry out a general cleaning of the pedal assisted bicycle;
- Remove the battery from its seat and place it in a suitable storage site (fully charged and recharged regularly);
- Leave the bicycle on a special support;
- Protect exposed electrical contacts with antioxidant products;
- Grease all surfaces not protected by paint or anti-corrosion treatments.

12. DISPOSAL OF COMPONENTS AND MATERIALS

Indications for waste treatment:

- Ferrous materials, aluminium, copper: these are recyclable materials to be taken to a specific authorized collection centre;
- Plastic materials, fibreglass, gaskets, tyres: these are materials to be sent to landfills or to a specific recycling centre;
- Batteries must be taken to authorized disposal centres.

Divide the materials according to their nature, appointing specialized companies authorized to dispose of them, in observance of the provisions of the law.

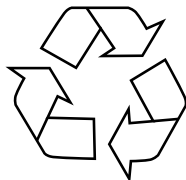

ATTENTION

DISPOSAL OF MATERIALS

Disposal of packaging, waste and vacuumed powders, of replaced parts and/or of the pedal assisted bicycle as a whole at the end of its expected life, must be carried out with respect for the environment, avoiding polluting the soil, water and air and in any case respecting the national and local regulations in force on the matter.



13. WARRANTY STANDARDS

M.B.M. S.r.l. Unipersonale guarantees that its bicycles are free from any manufacturing or workmanship defect. This warranty covers the repair or replacement of any part recognized as defective, subject to the following conditions.

TERMS AND CONDITIONS

- Guarantee period: the pedal assisted bicycle is guaranteed for 24 months on the mechanical and electrical parts, except for the batteries and all the components subject to wear. The batteries are covered by a 24-month limited warranty for correct use of the same:

- - first 6 months 100% coverage;
- - from the 7th to the 12th month, 50% coverage;
- - from the 13th to the 24th month, 25% coverage;

If the battery has been left to discharge below the permitted limit, the manufacturer is not liable for any damage.

- In order to make this guarantee effective, you must fill in the online form which can be accessed via QR CODE or by connecting directly to the website warranty.mmbike.it no later than 15 days from the date of purchase of the bicycle. You will need the serial number and photo proof of purchase from the authorized reseller. The serial number is placed inside the frame in the bottom bracket area, it is necessary to remove the battery cover by unscrewing your fixing screws (Fig. 15).

- Claims must be made through an official reseller by presenting the original fiscal document (receipt or invoice) and a printout of the confirmation of activation of the guarantee which you will receive by e-mail after completing the online form.

- The warranty provides for the free replacement of any defective or prematurely worn part provided that all the prescriptions have been complied with and improper use of the bicycle is not found. The manufacturer's obligations are limited to the replacement of defective parts.

- Finally, our Technical Department will decide whether or not the defective part or bicycle falls within the conditions of this guarantee.

- This warranty does not in any way cover the replacement of parts worn by normal use of the bicycle.

- This warranty does not apply in any case to failures or damage caused by improper use of the bicycle, use of the bicycle for sporting competitions, by the application of non-original accessories, or by improper maintenance interventio

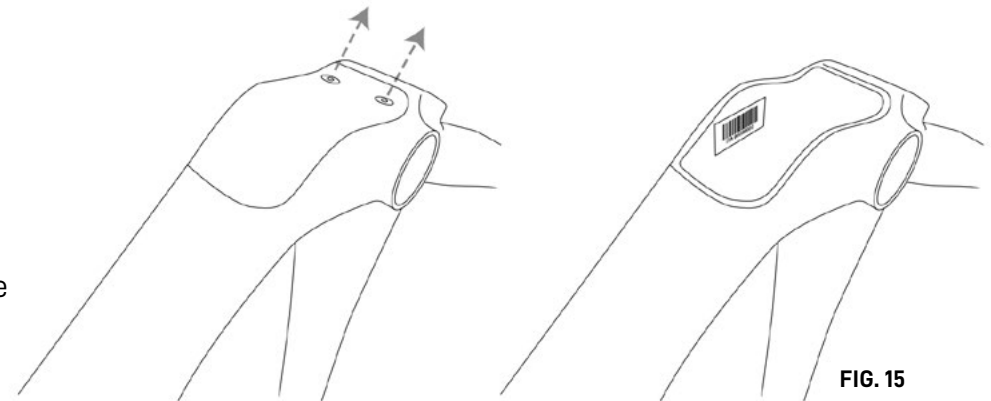

FIG. 15



ATTIVA QUI

LA GARANZIA



EXCLUSIONS

Normal wear and tear on parts subject to it, such as tyres, chains, brakes, cables and sprockets in situations where there are no material defects.

- Bicycles serviced by an unauthorized MBM distributor;
- Changes from the original packaging;
- Use of the bike for abnormal activities, such as competition and/or commercial activities, or for purposes other than those for which the bike was designed;
- Damage caused by failure to observe the user manual;
- Damage to paintwork or decals as a result of exposing the bike or riding it in harsh conditions and climates;
- Labor costs for the replacement of parts;
- Transportation fee.

Except as provided in this warranty and subject to all other warranties, MBM and its employees and agents shall not be liable for any loss or damage of any kind (including incidental or consequential loss or damage caused by negligence or default) arising out of or relating to any MBM bicycle.

The M.B.M. S.r.l. does not assume responsibility for damage to property and persons due to improper use of the vehicle.

14. CONFORMITY

Hybrid-drive bicycles with a maximum support speed of 25km/h fulfill the requirements:

- 2006/42/EC Machinery Directive;
- 2014/30/EU Electromagnetic Compatibility Directive;
- 2011/65/EU Rohs Directive

These bicycles also comply with the following non-harmonised standards:

- Electric bicycles: EN 15194

Disclaimer

We strongly recommend that you do not remove or replace any original equipment or modify your bicycle in any way that could change its design and/or function. Such modifications could seriously damage the handling, stability and other aspects of the bicycle, making it unsafe. The removal or modification of parts, or the use of non-original equipment as spare parts, can render the bicycle no longer compliant with applicable standards and laws. To guarantee safety, quality and reliability, use only original parts or MBM authorized spare parts for repair and replacement.





M.B.M. S.r.l. Unipersonale

Via Emilia Levante, 1671/73/75 | 47521 Cesena (FC)

Tel.: + 39 0547 -300364

Fax: +39 0547-304326

Email: info@mbmbike.it



W W W . M B M B I K E . I T